



BETTENERGY



All-In-One 13K-T

FUJIAN BETTENERGY TECHNOLOGY CO., LTD.

◆ All-in-one of inverter energy storage

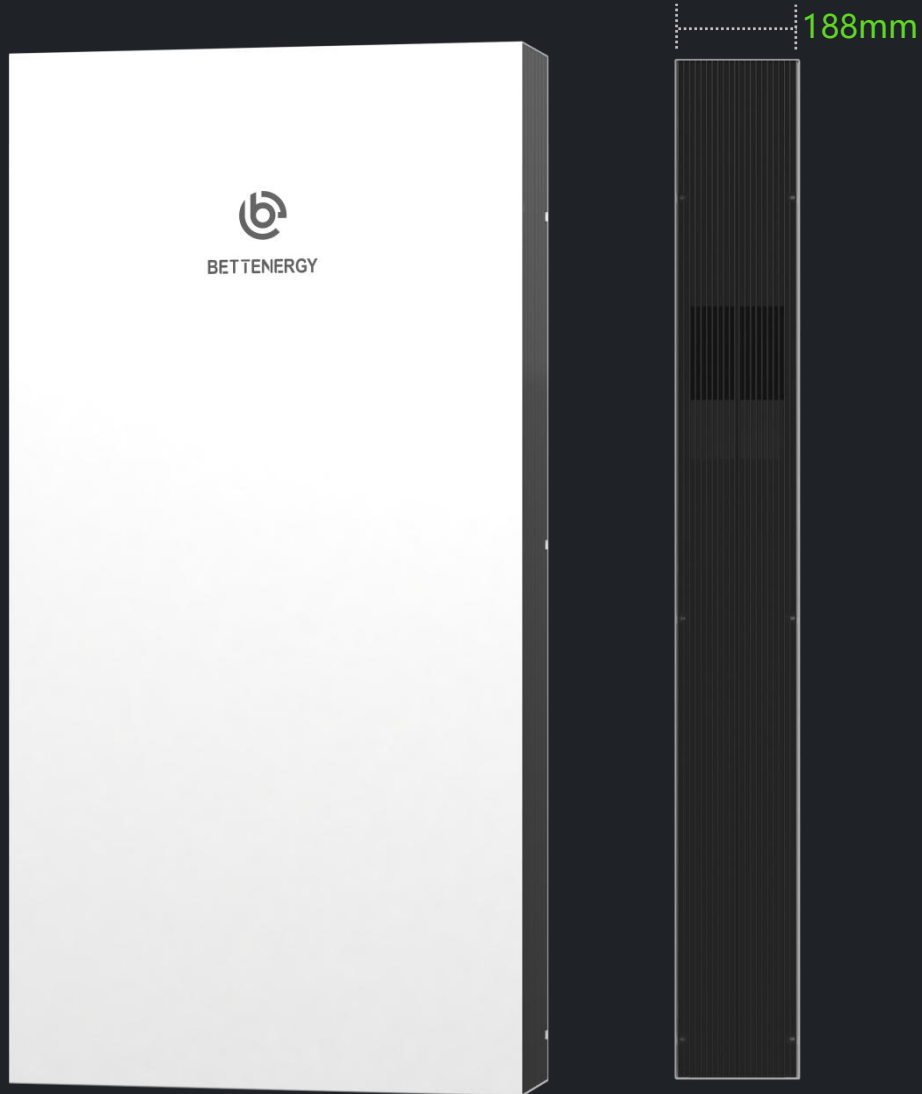

» Intelligent Cooling & Heating

Battery built-in thermal management liquid cooling module can provide heat dissipation for inverter and battery at the same time. The self-developed "Octopus" 8-channel reversing valve, with four cooling and three heating modes, can use the waste heat generated by the inverter to heat the battery in winter to ensure that the battery system operates at the optimal temperature! It increases the safety of the battery system and extends the service life of the system at the same time.



» CTP technology

The CTP (cell to pack) pack technology eliminates the electrical connection between the battery module structure and the pack, and integrates the cells directly into the pack, which not only increases the simplicity of battery installation but also improves the space utilization efficiency of the whole machine and reduces the transportation cost.



» Ultra-thin body

The World's Thinnest Inverter

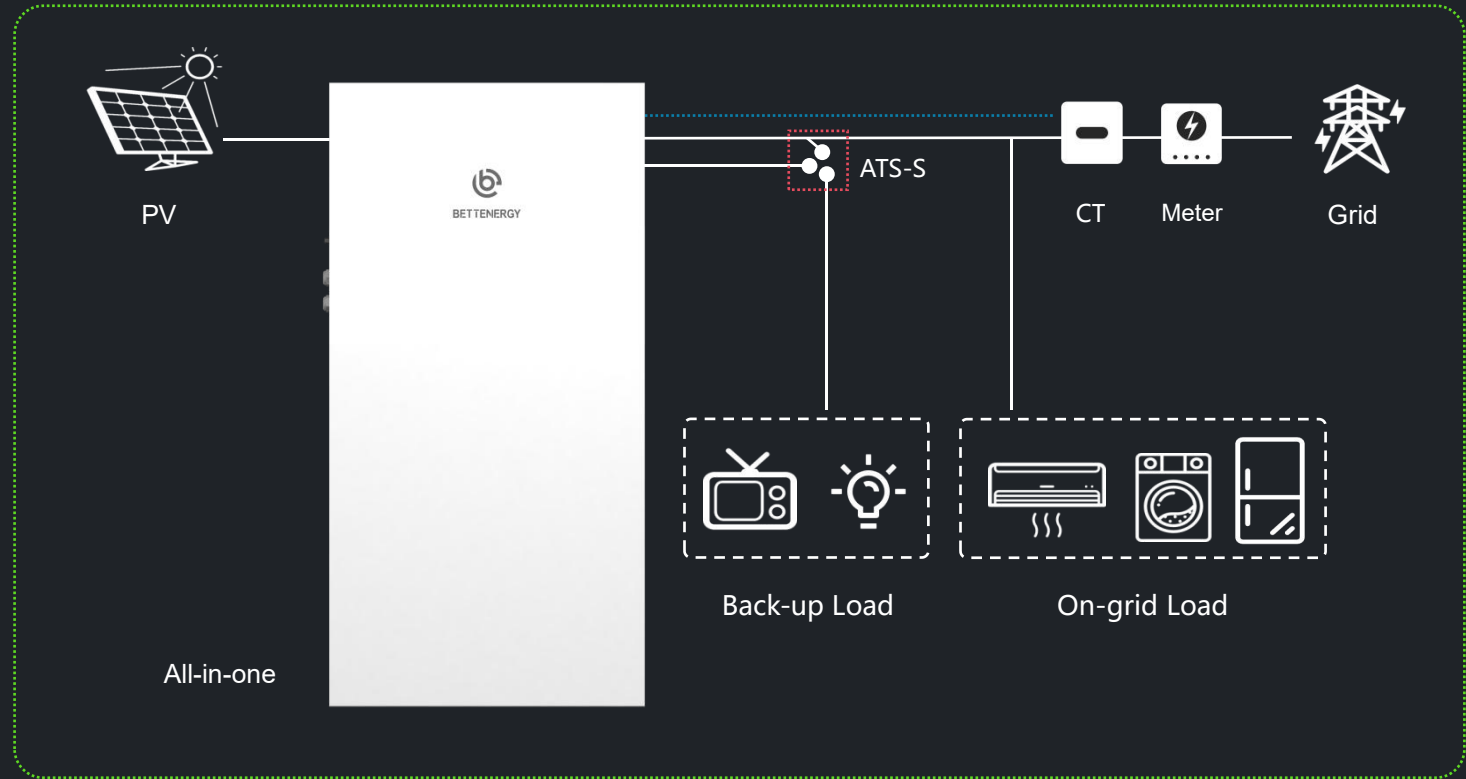

UN38.3



◆ All-in-one of inverter energy storage

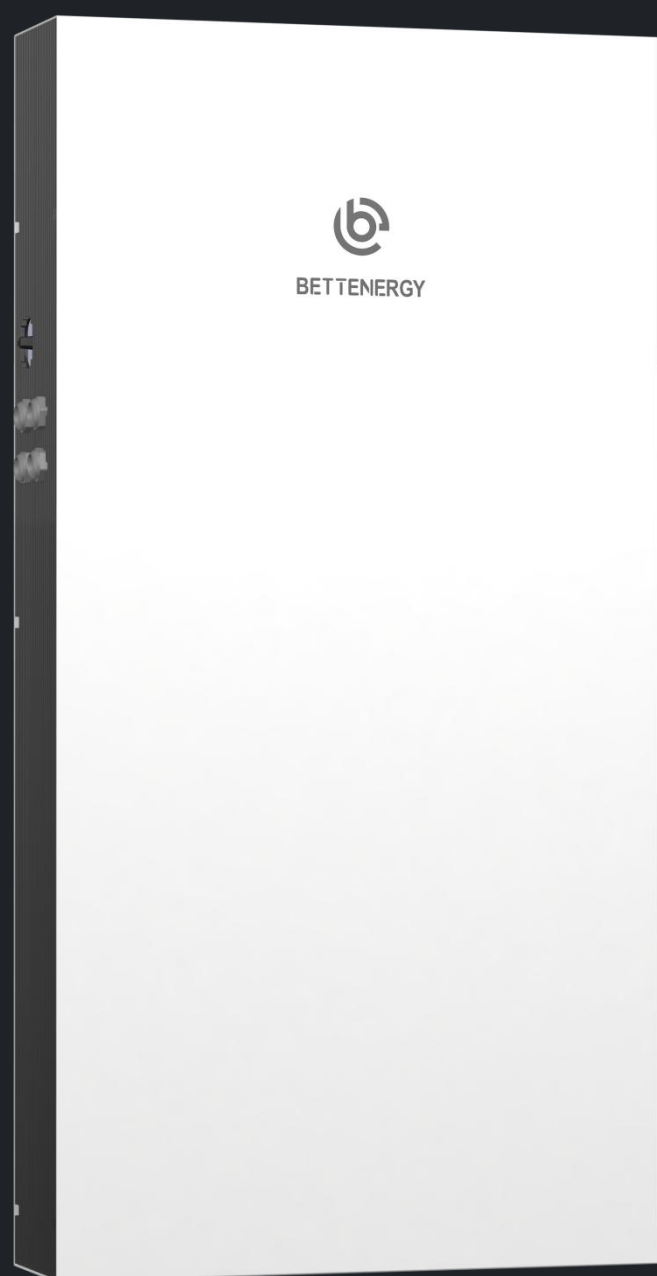

Model	AIO13K-T	
System parameter	Rated output power	13000W
	Protection level	IP65
	Warranty	10 years
	Grid connection type	3W+N+PE
	Battery usable capacity range	13kWh
PV input	Maximum PV input power	28000W
	No. of MPPT paths	4
	No. of MPPT inputs per circuit	1
	MPPT voltage range	180-850VDC
	Min. input voltage/starting voltage	125/235VDC
	Max. PV input current per circuit	20A
	Max. input voltage	1000VDC
AC output	Rated output power	13000W
	Rated output voltage	3W+N+PE,220/380V;230/400V; 240/415V
	Rated grid frequency	50Hz/60Hz;adaptive
	Rated output current	21A
	Power factor	0.8 ahead ~0.8 behind
	THDI	<3%
AC input	Rated Input Power	13000W
	Rated Input Current	21A
	Grid voltage range	360V-440V
	Rated grid frequency	50Hz/60Hz;adaptive
Off-grid output	Rated output power	13000W
	Rated output voltage	3W+N+PE,220/380V;230/400V; 240/415V
	Output frequency	50Hz/60Hz;adaptive
	Instant power	26000W
	Rated output current	21A
	Cutover time	≤10ms
	THDU, Linear Load	<3%
Battery parameters	Battery Type	LFP
	Battery capacity	13.4kWh
	Rated voltage	268.8V
	Battery voltage range	252~303V
	Rated charge/discharge current	50A/50A
Efficiency	MPPT efficiency	≥99.5%
	Max. efficiency	98.2%
	European efficiency	97.5%
	Max. battery charge/discharge efficiency	97.5%
Basic parameters	External Communication Methods	WiFi
	Heat dissipation method	Fully liquid-cooled
	Dimensions (mm) (H*W*D)	1382*670*188
	Product Net Weight	125kg
Environmental constraints	Operating temperature range	-20-55°C
	Operating humidity	≤95%rh
	Storage environment humidity	≤95%rh
	Operating altitude	≤3000m
	Storage temperature	≤25°C, 12 months
		≤35°C, 6 months
≤45°C, 3 months		
Accreditation	TUV,RoHS,MSDS,UN38.3,IEC62619,CE	

Contact Us



400-678-6679



sales@bettenergy.com



www.bettenergy.com



Sanming Production Center: 4th Floor, Building 2, Intelligent Manufacturing Industrial Park, Gongye South Road, Ninghua County, Sanming City, Fujian Province, China



R&D Operation Center: S108, Weiye Building, No. 11 Torch East Road, Business Park, Torch High-tech Zone, Huli District, Xiamen China.



Fuzhou branch: Fuzhou Taji District Yizhou Street Industrial Road 173 Fuzhou Sandi Yuexing International Home Plaza First Floor Exhibition Hall C8018



BETTENERGY